

Specifications:
 Input Voltage Max: 250VAC
 Rated Current Max: 4A
 Earth Requirement: No
 Ingress Protection: IP20
 Material: Porcelain & ceramic
 Base Type: Edison Screw, ES, E27
 Entry Type: Batten
 Shade Nut: No
 Height: 60mm
 Diameter: 76mm
 Certifications: RCM SAA-161024-EA, CE

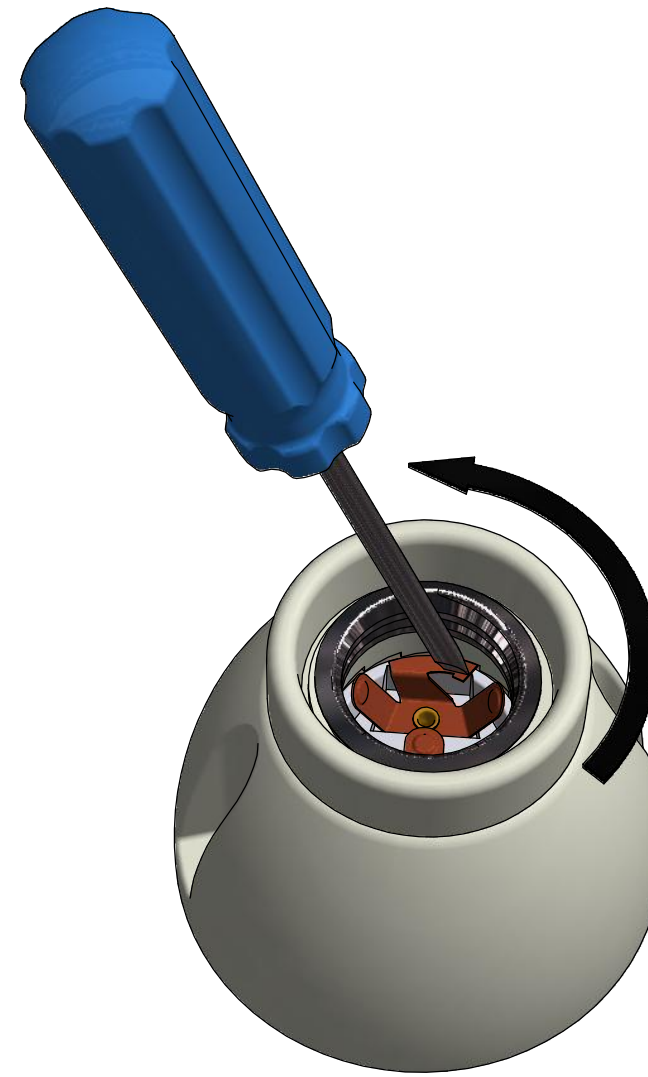
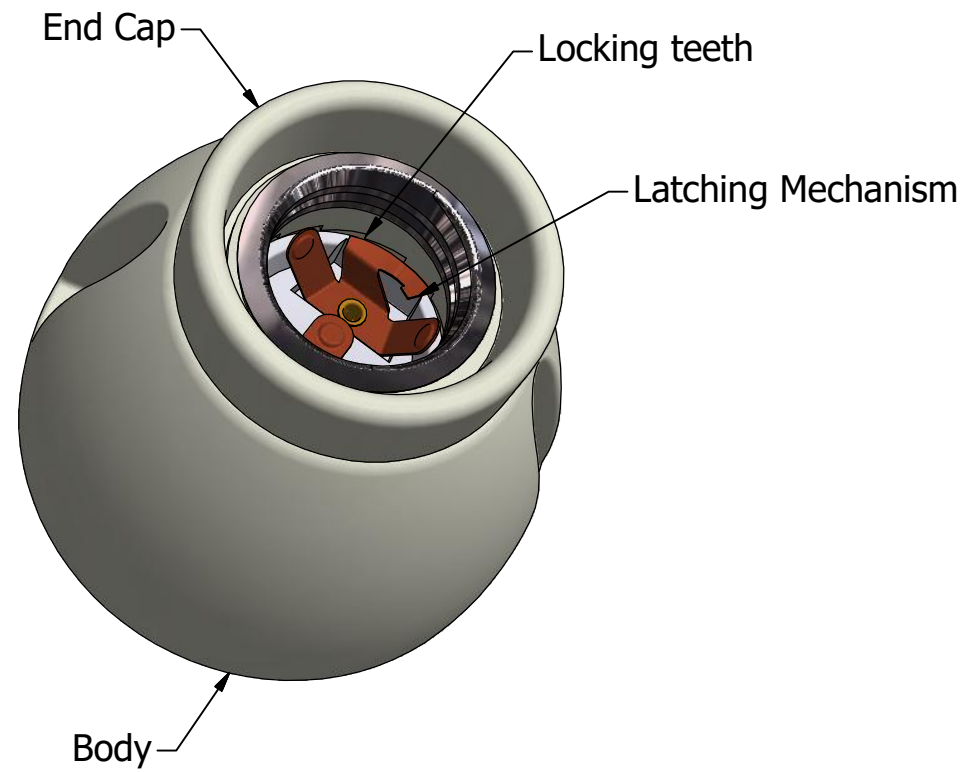

BEFORE ATTEMPTING DISASSEMBLY

This lamp holder is equipped with an anti-rotation feature that must be circumnavigated before unscrewing the end cap.

With a small screwdriver, press down on the anti-rotation latch connected to the neutral contact blade, whilst at the same time, unscrew the end cap from the body.

Edison Light Globes globes, flex and fittings



REVISION HISTORY				
REV	DESCRIPTION	DATE	APPROVED	CR
A0	Initial Release		PG	

USE ONLY FOR JOB NO.	Material	Finish		
	SCALE: DNS	© Edison Light Globes Pty Ltd edisonlightglobes.com		
UNCONTROLLED DOCUMENT	Designed by davidgreenwood	Checked by	Approved by PG	Date 12-Oct-16
	Dimensions in millimetres Limit on untoleranced unmachined dimensions ± 0.2mm No decimal place 1mm 1 decimal place ± 0.3mm 2 decimal places ± 0.1mm General unmachined angular tolerance ± 1° Tolerance to be non-cumulative		Porcelain Batten Holder Installation Revision Sheet 1 / 1	